

3 February 2023  
Job No: 1000780.1000-R6.v1

Maribyrnong Riverside Development Pty Ltd  
c/o YourLand Developments Pty Ltd  
Level 1, 68 Clarke Street  
Southbank Vic 3006

Attention: Ronan Tongs

Dear Ronan

## Level 1 GITA, Lot Fill Certificates - Lots #11 to #20, Stage 7C, River Valley Estate, Sunshine North

### 1 Introduction

Tonkin and Taylor Pty Ltd (T+T) was engaged by Maribyrnong Riverside Development Pty Ltd (MRD), to provide Level 1 Geotechnical Inspection and Testing Authority (GITA) services for the bulk earthworks conducted within Stage 7C of the River Valley Estate in Sunshine North between April 2021 and July 2021.

The following two separate Level 1 GITA reports were provided on the bulk earthworks for Stage 7C supervised by T+T:

- The Eastern part of Stage 7C<sup>1</sup> (also known as the Reserve).
- The Western part of Stage 7C<sup>2</sup> (also known as the Upper Lots), Lot 11 to Lot 20.

Chadwick Geotechnics Pty Ltd (Chadwick Geotechnics), a subsidiary of T+T, carried out the fieldwork and laboratory testing for this project.

As part of the Stage 7C West, Douglas Partners Pty Ltd (DP) designed a Reinforced Earth Retaining Wall (RERW) with a rock facade within the eastern part (the downhill side) of the upper residential lots, abutting T+T Level 1 Fill. The construction of the retaining wall was conducted under full time supervision by DP and is documented separately in their Level 1 GITA Report<sup>3</sup>.

In accordance with AS3798-2007 "Guidelines on Earthworks for Commercial and Residential Development", Level 1 GITA services require full time inspection, and field and laboratory testing of earthworks in accordance with AS1289 "Methods of Testing Soils for Engineering Purposes".

### 2 Purpose of this Letter

MRD engaged T+T to monitor the Level 1 GITA works for the RERW undertaken by DP to be able to provide Lot Fill Certificates for the upper 10 lots, taking into consideration DP's Level 1 Report.

---

<sup>1</sup> T+T Report reference 1003809.1000.7C East v1, dated November 2022.

<sup>2</sup> T+T Report reference 1003809.1000.7C West v1, dated January 2022

<sup>3</sup> DP Earthworks Closure Report, River Valley Estate Stage 7C - Wall 7C, Project 95572.02, Dated January 2023

This letter is to be issued to Council as a supporting document for the issuance of the Certificate of Compliance (COC) by the Council for the Lots #11 to #20.

## 3 Project Details

### 3.1 Location

River Valley Estate is in the western Melbourne suburb of Sunshine North. The estate extends on both sides of River Valley Boulevard located to the west of Maribyrnong River.

Stage 7C West of River Valley Estate, comprises of eleven (11) upper lots and eleven (11) lower lots.

The upper lots, namely Lot 11 to Lot 20, located to the east of Perennial Drive as shown in the extract from the Detailed Layout Plan presented in Figure 3-1, are included in this report.

The lower lots shown in Figure 3-1 did not have fill placed under level 1 GITA and hence not included in this document.

The Reserve on the downhill part of the site (Stage 7C East), was previously completed and is reported separately by T+T.

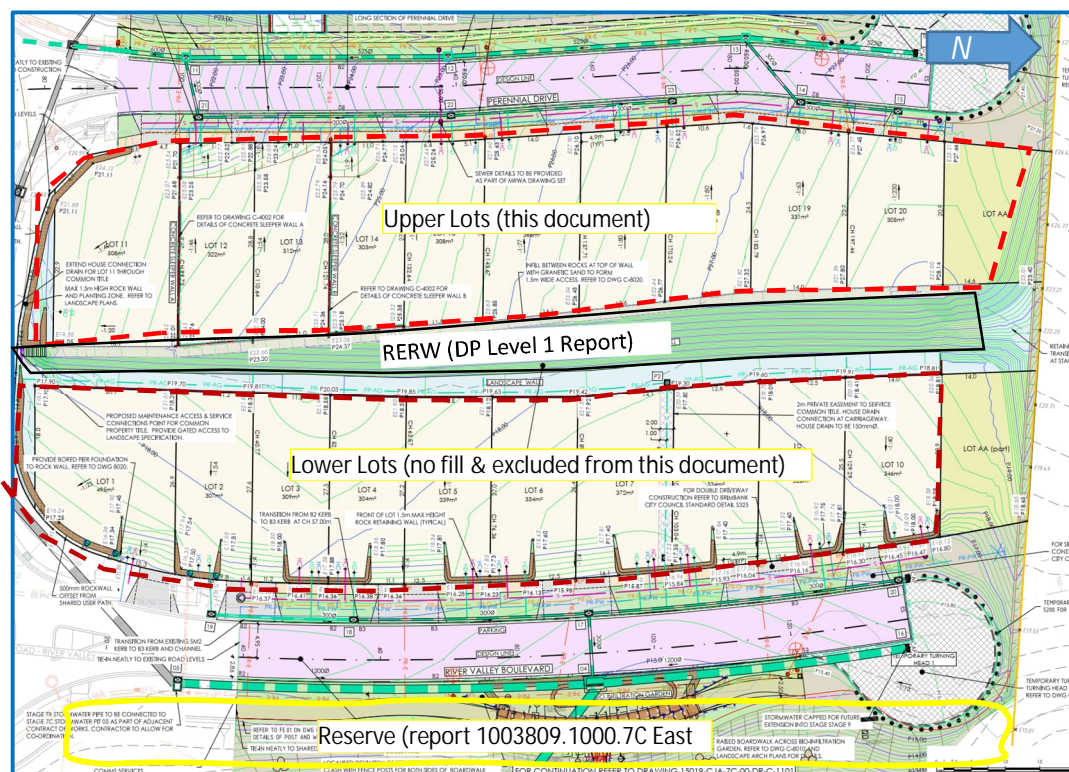

Figure 3-1: Stage 7C – extract from CJ Arms drawing 'Detailed Layout Plan'

### 3.2 Roles on the Project

The organisations involved and their roles are presented in Table 3-1

Table 3-1: Roles on the project

Organisation	Role
Maribyrnong Riverside Development Pty Ltd	Developer
YourLand Developments Pty Ltd	Development Manager
Tonkin & Taylor Pty Ltd	Bulk earthworks Geotechnical Engineer and Earthworks Specifications
Chadwick Geotechnics Pty Ltd	Bulk earthworks Geotechnical Inspection and Testing Authority (GITA)
CJ Arms Pty Ltd	Designer / Superintendent
Winslow Constructors Pty Ltd	Earthworks Contractor
Douglas Partners Pty Ltd	RERW geotechnical designer
Douglas Partners Pty Ltd	RERW Level 1 GITA

Chadwick Geotechnics undertook the field density testing for the bulk earthworks. The compaction control laboratory testing was conducted in the Ravenhall NATA accredited laboratory, as part of the Level 1 GITA process.

### 3.3 Dates on site

Geotechnical technician and engineering staff from our company were onsite on the days shown in Table 3-22 below to carry out Level 1 GITA services of the bulk earthworks for the Upper Lots.

Table 3-2: Dates on site – Level 1 GITA by T+T during bulk earthworks

Month	Date
May 2021	8, 13, 17, 18, 19, 21, 22, 26, 27 and 29
July 2021	6 and 7

Once the bulk earthworks were completed, Level 1 GITA personnel from DP supervised the construction of the RERW between November 2021 and November 2022 (detailed in DP's Level 1 Report<sup>3</sup>). Personnel from T+T carried out site visits on dates presented in Table 3-3 and conducted 3<sup>rd</sup> party overview of DP's Level 1 works.

Table 3-3: Dates on site by T+T – visits during RERW construction

Month	Date
April 2022	26, 29
May 2022	11, 27
June 2022	10, 15
October 2022	19, 20, 21, 25, 27, 28
November 2022	8, 18, 24, 25, 28

### 3.4 Included Areas

This document is applicable to material placed as part of the bulk earthworks (Level 1 GITA services by Chadwick Geotechnics) and the RERW works (Level 1 GITA service by DP) carried out by Winslow within Stage 7C West.

The included areas are detailed in the respective Level 1 GITA reports noted in Section 1 of this document. Extracts from the site plans and cross sections showing the included areas are presented below.

The area filled under Chadwick Geotechnics's Level 1 GITA Services is shown on the extract presented in Figure 3-2 sourced from CJ Arms drawing<sup>4</sup> presented in Appendix A.

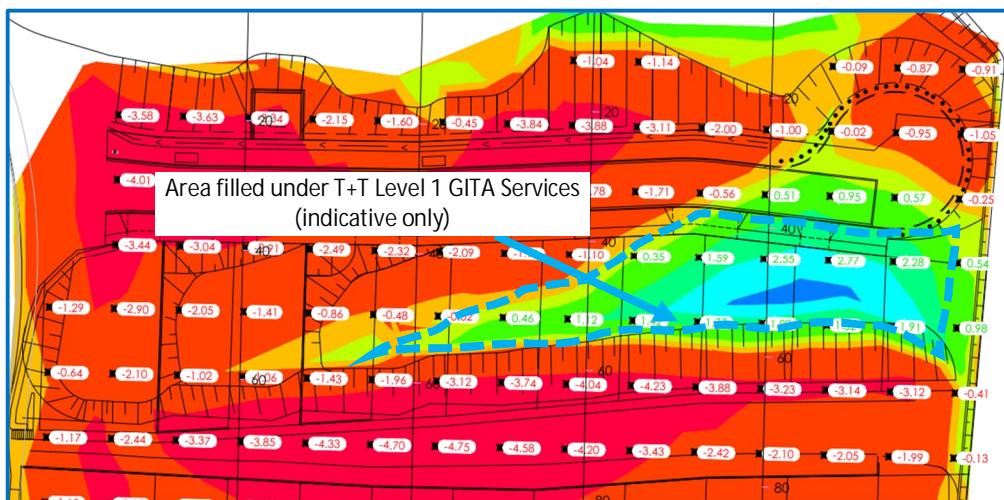

Figure 3-2: Extract from CJ Arms showing area supervised by Chadwick Geotechnics

The area filled under DP's Level 1 GITA Services is shown on the extract shown on Figure 3-3 sourced from CJ Arms drawing<sup>5</sup> presented Appendix A.

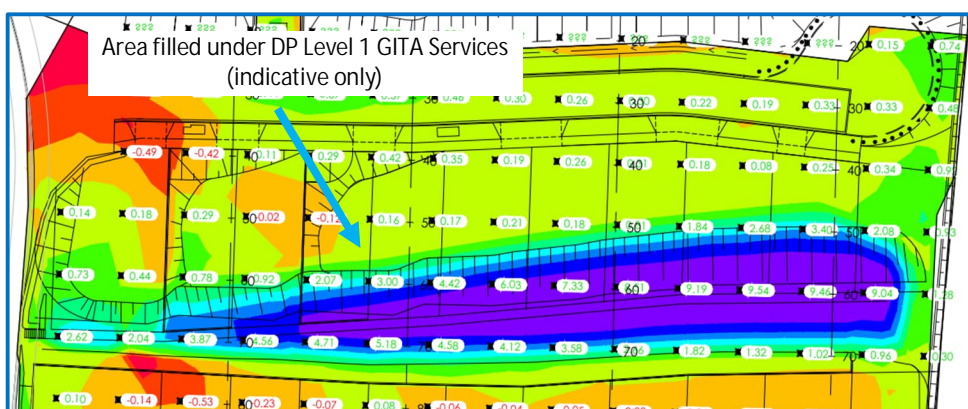

Figure 3-3: Extract from CJ Arms showing area supervised by DP

An extract from longitudinal section indicating the areas supervised by T+T and DP is shown on Figure 3-4 sourced from CJ Arms drawing<sup>6</sup> presented in Appendix A.

<sup>4</sup> CJ Arms drawing titled 'Volume Comparison, As Built Bulk Level vs Existing Ground Level'. Drawing no.:9502 Rev P01 dated 20.10.'22

<sup>5</sup> CJ Arms drawing titled 'Volume comparison, As Built FS Level VS As Built BS Level'. Drawing no.:9503 Rev P01 dated 12.12.'22

<sup>6</sup> CJ Arms drawing titled 'Typical Sections – Site Sections', Sheets 2 of 2. Drawing no.:9602 Rev P01 dated 12.12.'22 .

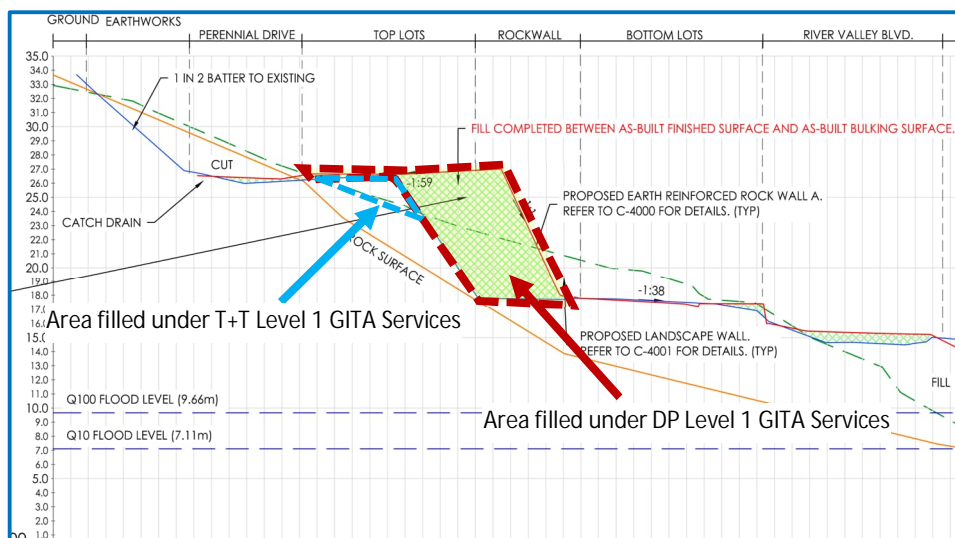

Figure 3-4: Extract from CJ Arms drawing sectional view of areas supervised by Chadwick Geotechnics and DP

## 4 Geotechnical construction monitoring

As noted in Section 1 of this document, Chadwick Geotechnics were engaged to conduct Level 1 GITA supervision of the bulk earthworks for the Upper Lots, and to do the construction monitoring of the Level 1 GITA Services of the RERW conducted by DP.

Chadwick Geotechnics personnel conducted the third party monitoring of the Level 1 GITA Services carried out by DP at the site on the dates noted in Section 3.3 of this document. Based on our observations, T+T were satisfied with the quality of the construction supervision works conducted by DP on the RERW during our visits.

## 5 Conclusion

On the basis of our inspections and after considering the Level 1 GITA reports by Chadwick Geotechnics and DP relating to the project, T+T concludes the following, as far as reasonably practicable:

- The materials used by the earthwork contractor satisfied the material property requirements given in the specification.
- The sourced fill was considered to be clean and suitable for use at the site.
- The fill material placed was tested at frequency specified in Table 8.1 of AS 3798-2007 and the results indicated that the compacted materials achieved the target density requirement given in specification.
- Given the consistent construction practices followed by the earthworks contractor, as observed by T+T, combined with the compliance of the test results to the requirement specified in the specification, it is considered that earthworks areas of the site between test locations were performed to the same standard as that of the areas that were tested.
- Based on observations made by the Level 1 personnel and the results of field and laboratory tests, we consider that the engineered fill placed by Winslow within Stage 7C West (Lots 11 to 20 and Lot AA) to the levels shown in the survey drawing presented in Appendix A, is considered to have been placed in general accordance with the requirements of the specifications.

- The earthworks undertaken have been performed in accordance with the requirements of Section 8.2, Level 1 Inspection and Testing, of AS3798-2007 "Guidelines on Earthworks for Commercial and Residential Developments".

## 6 Applicability

This document has been prepared for the exclusive use of our client Yourland Pty Ltd in good faith and in accordance with the Tonkin and Taylor and Chadwick Geotechnics quality system for the earthworks at the site.

This report is based on the nature of the project and the prevailing conditions between 30 April 2021 and 30 November 2022. Where there has been a change in the nature of the project or the conditions on site that may alter or affect the conclusions of this report, no responsibility or liability will be accepted, and T+T is indemnified to the full extent permitted by law in respect to the use of this report

Should you require any further information regarding this report, please do not hesitate to contact the undersigned on (03) 8796 7900.

Tonkin & Taylor Pty Ltd

Report prepared by:



.....  
Sotir Stojcevski  
Earthworks Engineering Team Leader – Ravenhall

Report prepared by:



.....  
Suresh Seetharaman  
Associate Geotechnical Engineer

Authorised for Tonkin & Taylor Pty Ltd by:



.....  
Trevor Smith  
Project Director

3-Feb-23

\\ttgroup.local\corporate\dandenong\geo projects\1003809\1003809.1000\workingmaterial\lot certificates report - 7c upper lots\1003809.1000 7c west - lot fill certificates.docx

### Appendices

Appendix A	Drawings/Figures
Appendix B	Cross Sections
Appendix C	Lot Fill Certificates

## Appendix A Drawings/Figures

---

VOLUMETRIC ANALYSIS				
NUMBER	COLOUR	MIN ELEVATION (m)	MAX ELEVATION (m)	2D AREA (m <sup>2</sup> )
1	Red	-1.647	-1.000	116.7
2	Orange	-1.000	-0.500	822.9
3	Yellow	-0.500	0.000	5340.2
4	Light Green	0.000	0.500	10192.0
5	Green	0.500	1.500	2732.2
6	Dark Green	1.500	2.500	386.8
7	Cyan	2.500	3.500	330.1
8	Blue	3.500	4.500	310.8
9	Dark Blue	4.500	6.000	388.4
10	Purple	6.000	9.680	830.8

**BULK EARTHWORKS NOTES**

THE APPROXIMATE SITE EARTHWORKS VOLUMES BASED ON THE AS-BUILT FINISHED SURFACE COMPARISON TO THE AS-BUILT BULK EARTHWORKS SURFACE ARE:

- VOLUME OF CUT: 15 990m<sup>3</sup>
- VOLUME OF REMAINING FILL: 1 553m<sup>3</sup>

**VOLUMES REQUIRED TO ACHIEVE AS-BUILT FINISHED LEVELS**

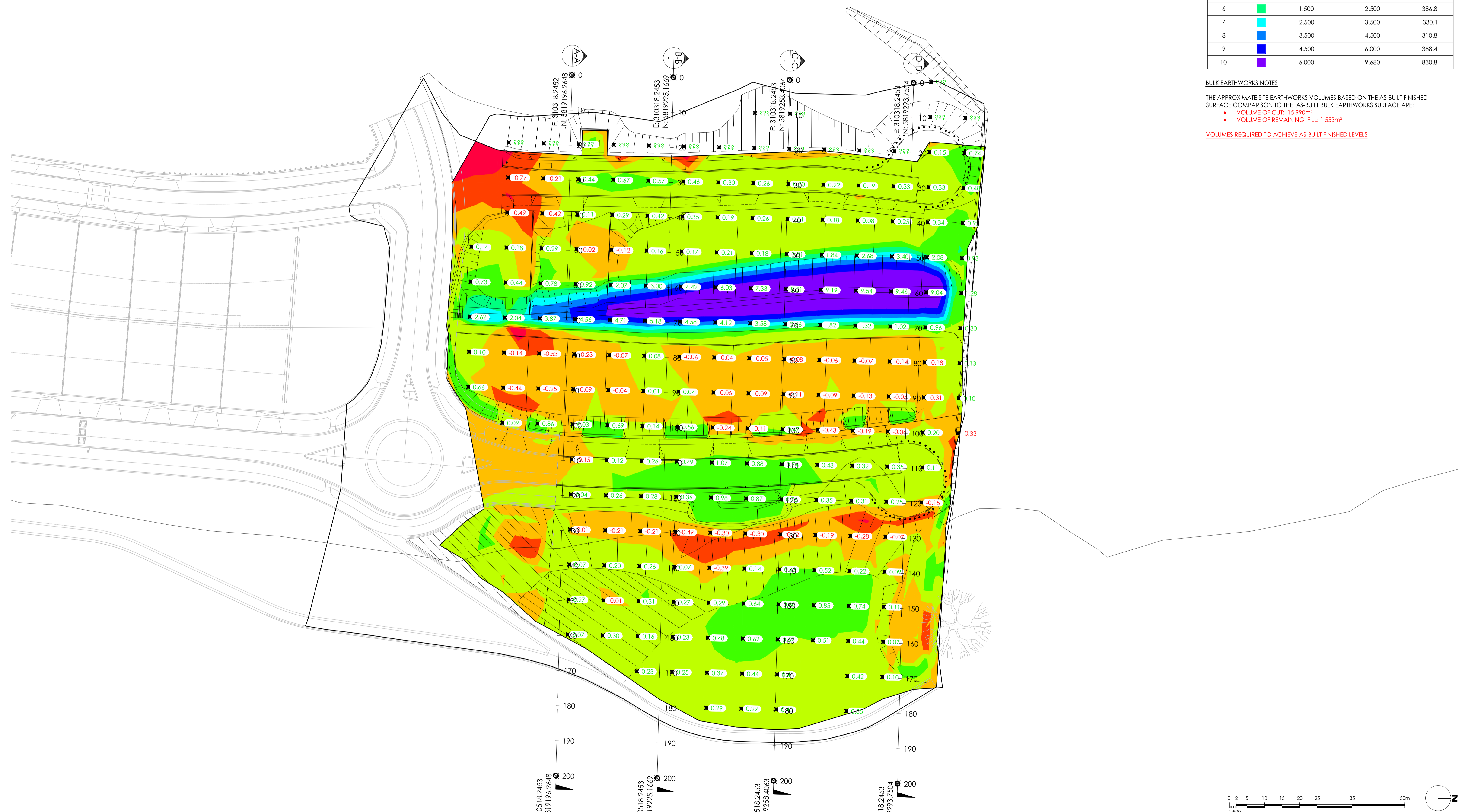

NO	DATE	FOR INFORMATION	TS	VE
	12/12/22			

**Note for Contractors**  
The works described on this drawing must be undertaken by competent Contractors with an appropriate level of experience who have prepared appropriate Safe Work Method Statements (SWMS) relating to these works. The contractor is responsible for the management of all risks associated with the construction activities stated on this drawing.

This drawing should not be issued in part and must be read in conjunction with all appropriate specifications, notes pages, details and authority drawings as appropriate.

Be aware of underground services. The location of underground services are approximate only and their exact position should be proven on site. No guarantee is given that existing services are shown.

www.cjarms.com

# CJ ARMS

SKETCHES

MELBOURNE  
T: (03) 9283 2800 | E: info@cjarms.com | W: www.cjarms.com

Project: RIVER VALLEY - STAGE 7C  
Client: YOURLAND  
Drawing Title: VOLUME COMPARISON AS-BUILT FS LEVEL VS AS-BUILT BS LEVEL

Project Number	Origin	Zone	Level	File Type	Rev	Number	Revision
15019	CJA	7C	XX	SK	C	9503	PO1



VOLUMETRIC ANALYSIS				
NUMBER	COLOUR	MIN ELEVATION (m)	MAX ELEVATION (m)	2D AREA (m <sup>2</sup> )
1	Red	-5.841	-3.000	3147.6
2	Orange	-3.000	-0.500	9381.8
3	Yellow	-0.500	0.000	4092.8
4	Light Green	0.000	0.500	2458.2
5	Green	0.500	1.500	1686.6
6	Light Blue	1.500	2.500	993.2
7	Blue	2.500	3.500	722.6
8	Dark Blue	3.500	4.500	482.2
9	Very Dark Blue	4.500	5.500	325.2
10	Purple	5.500	6.630	312.4

**BULK EARTHWORKS NOTES**

THE APPROXIMATE SITE EARTHWORKS VOLUMES BASED ON THE AS-BUILT BULK EARTHWORKS SURFACE COMPARISON TO THE EXISTING NATURAL GROUND SURFACE ARE:

- VOLUME OF CUT: 27 358m<sup>3</sup>
- VOLUME OF REMAINING FILL: 11 540m<sup>3</sup>

**VOLUMES REQUIRED TO ACHIEVE AS-BUILT BULK LEVELS**

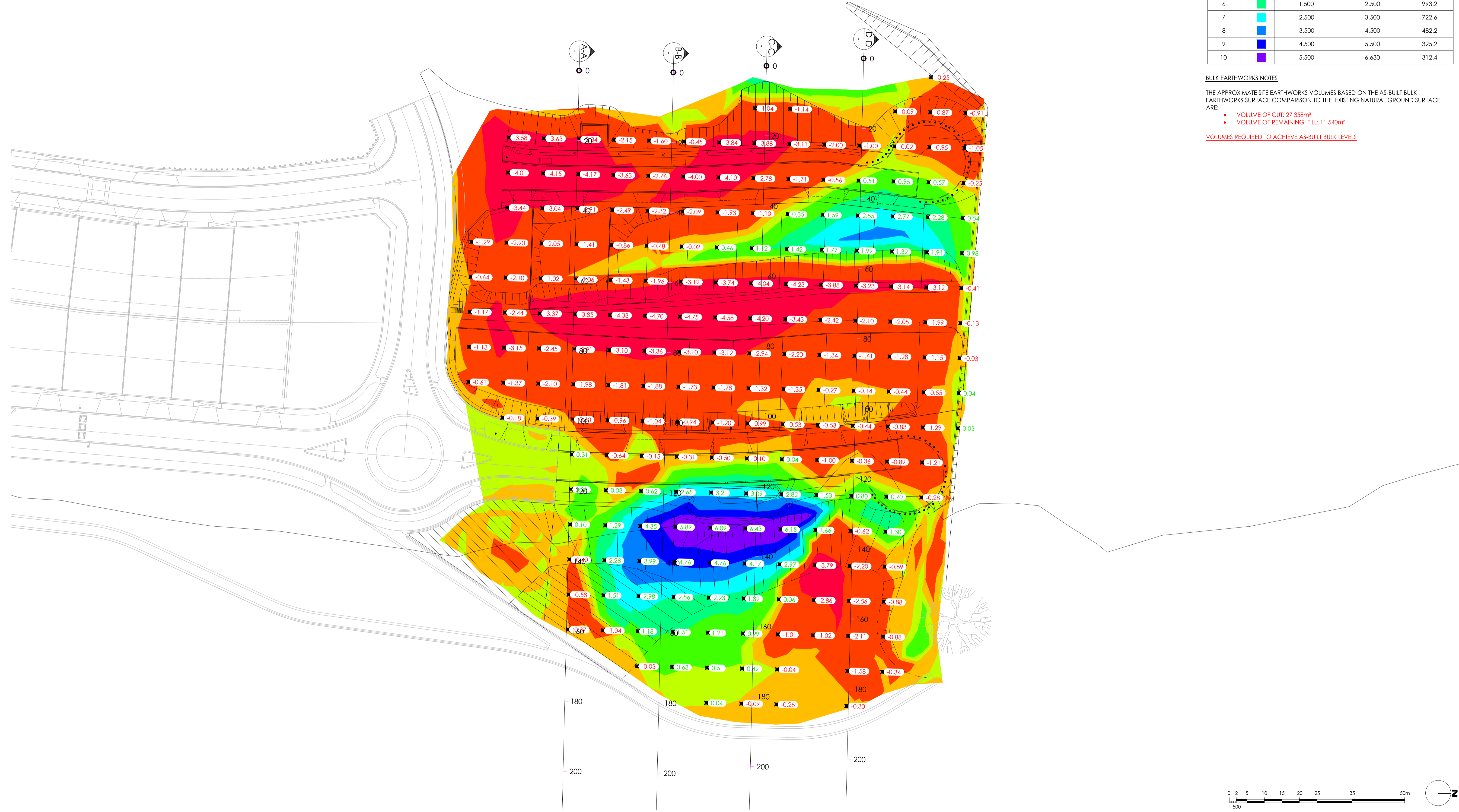

NO	DATE	BY	CHKD
1	20.10.22	TS	VF
FOR INFORMATION		Drawn	Checked

**Note for Contractors**  
The works described on this drawing must be undertaken by competent Contractors with an appropriate level of experience who have prepared appropriate Safe Work Method Statements (SWMS) relating to these works. The contractor is responsible for the management of all risks associated with the construction activities stated on this drawing.

This drawing should not be issued in part and must be read in conjunction with all appropriate specifications, notes pages, details and authority drawings as appropriate.

Be aware of underground services. The location of underground services are approximate only and their exact position should be proven on site. No guarantee is given that existing services are shown.

www.cjarms.com

# CJ ARMS

SKETCHES

MELBOURNE  
T: (03) 9583 2800 | E: info@cjarms.com | W: www.cjarms.com

Project: RIVER VALLEY - STAGE 7C  
Client: YOURLAND  
Drawing Title: VOLUME COMPARISON AS-BUILT BULK LEVEL VS EXISTING GROUND LEVEL  
For Information

Project Number	Origin	Zone	Level	File Type	Rev	Number	Revision
15019	CJA	7C	XX	SK	C	9502	P01

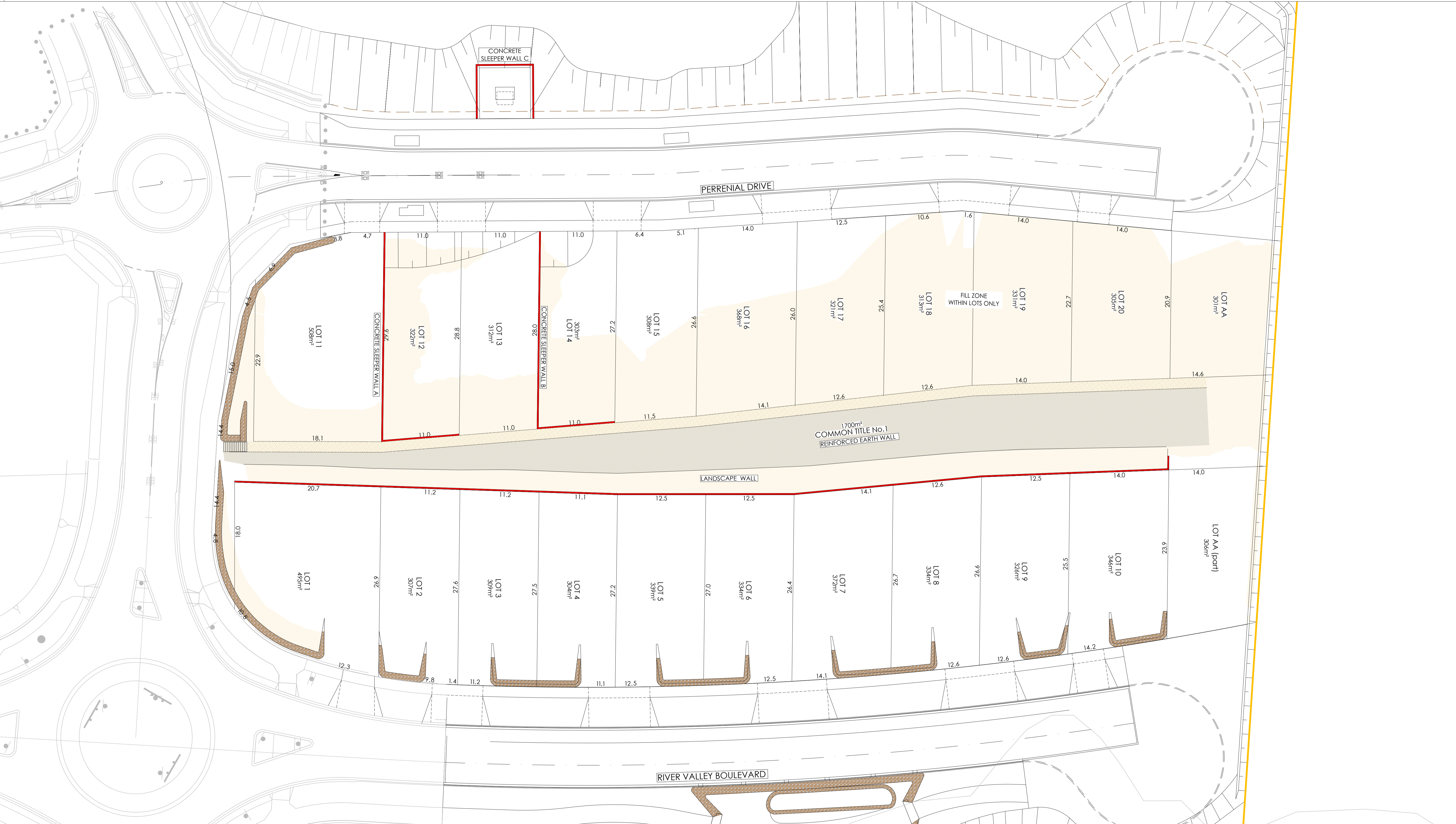

**LEGEND**

	FILL (+300mm)
	RETAINING WALL (CONCRETE SLEEPER)
	RETAINING WALL (ROCKWORK)

**DRAWING NOTES:**

- THIS PLAN DETAILS AREAS IN WHICH GREATER THAN 300mm OF FILL WILL BE PLACED ON TOP OF THE NATURAL SURFACE OF THE LAND WITHIN THE SUBDIVISION AS A RESULT OF THE PROPOSED WORKS.
- THIS PLAN DOES NOT DETAIL ANY OTHER FILL MATERIAL THAT MAY HAVE BEEN PLACED WITHIN THE SUBDIVISION PRIOR TO THE CIVIL WORKS BEING UNDERTAKEN.
- IRRESPECTIVE OF THE DEPTH OF FILL DETAILED ON THIS PLAN, FOUNDATIONS MUST BE DESIGNED AND CONSTRUCTED IN ACCORDANCE WITH BUILDING REGULATIONS AND WILL TAKE INTO ACCOUNT THE SOIL CLASSIFICATION AND SOIL REPORT PREPARED FOR EACH INDIVIDUAL LOT.
- THE EXTENT AND DEPTH OF FILL SHOWN ON THIS PLAN WILL BE CONFIRMED ON-SITE BY A GEOTECHNICAL INVESTIGATION BY A REGISTERED AND EXPERIENCED GEOTECHNICAL ENGINEER.

1	18.12.2022	ISSUED FOR AS-CONSTRUCTED	TS	VR
0	03.09.2021	ISSUED FOR CONSTRUCTION	JSS	AK
Reviewed	Date	Reason	Drawn	Checked

**Note for Contractors**  
This works described on this drawing must be undertaken by competent Contractors with an appropriate level of experience who have prepared appropriate Safe Work Method Statements (SWMS) relating to these works. The contractor is responsible for the management of all risks associated with the construction activities stated on this drawing.

This drawing should not be issued in part and must be read in conjunction with all appropriate specifications, notes pages, details and authority drawings as appropriate.

Dial before you dig. BEWARE OF UNDERGROUND SERVICES. The location of underground services are approximate only and their exact position should be proven on site. No guarantee is given that existing services are shown.

ISSUED FOR AS-CONSTRUCTED

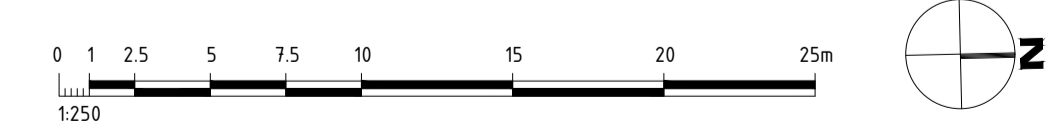

YourLand  
Developments

CJ ARMS

CIVIL SITWORKS  
MELBOURNE  
T: (03) 9283 2800 | E: info@cjarms.com | W: www.cjarms.com

Project: RIVER VALLEY - STAGE 7C  
Client: YOURLAND  
Drawing title: FILL LAYOUT PLAN

Drawn By: JSS	Checked By: AC	Drawn Scale: 1:250 @ A1	Date of first issue: 22.07.20
Project Number: 15019	Client: CJA	Zone: 7C	Level: XX
File Type: DR	Rev: C	Number: 9900	Revision: 1

www.cjarms.com

## Appendix B Cross Sections

---

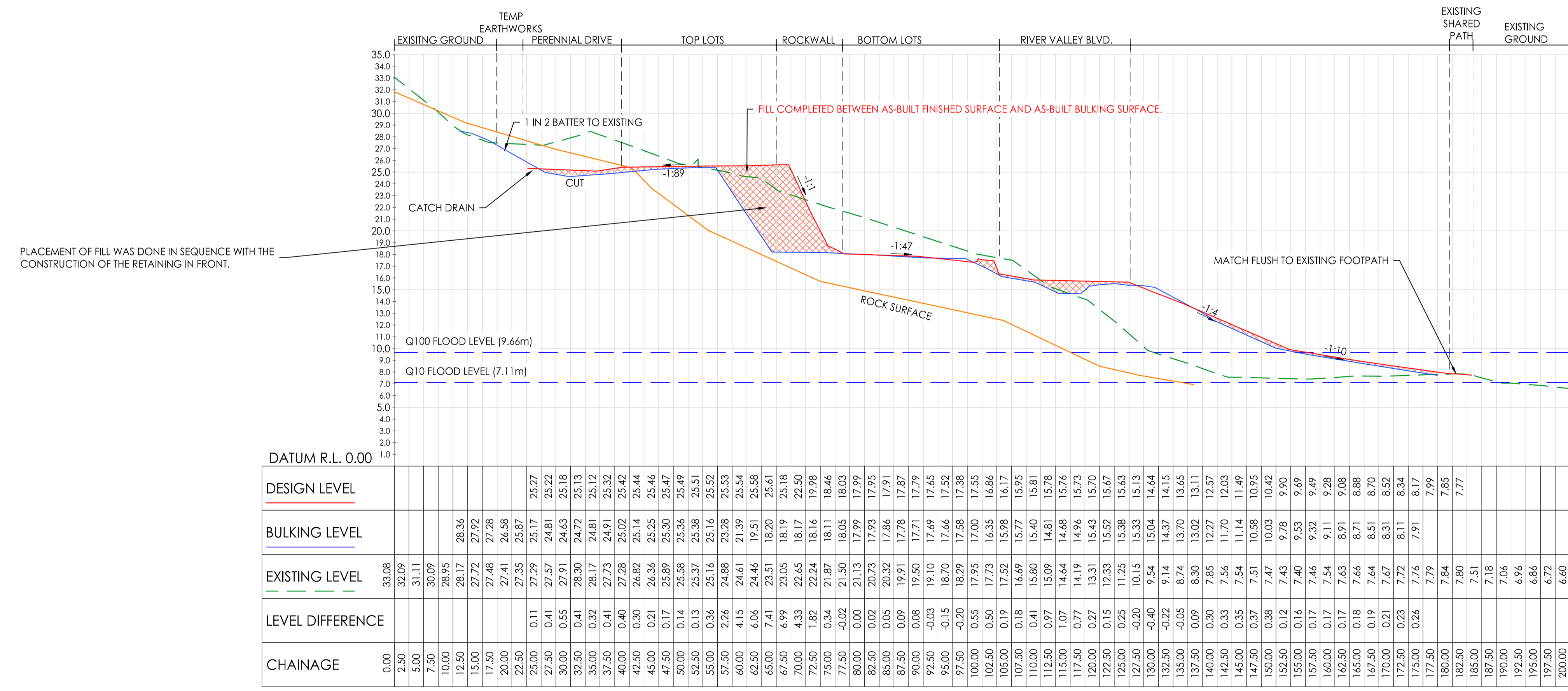
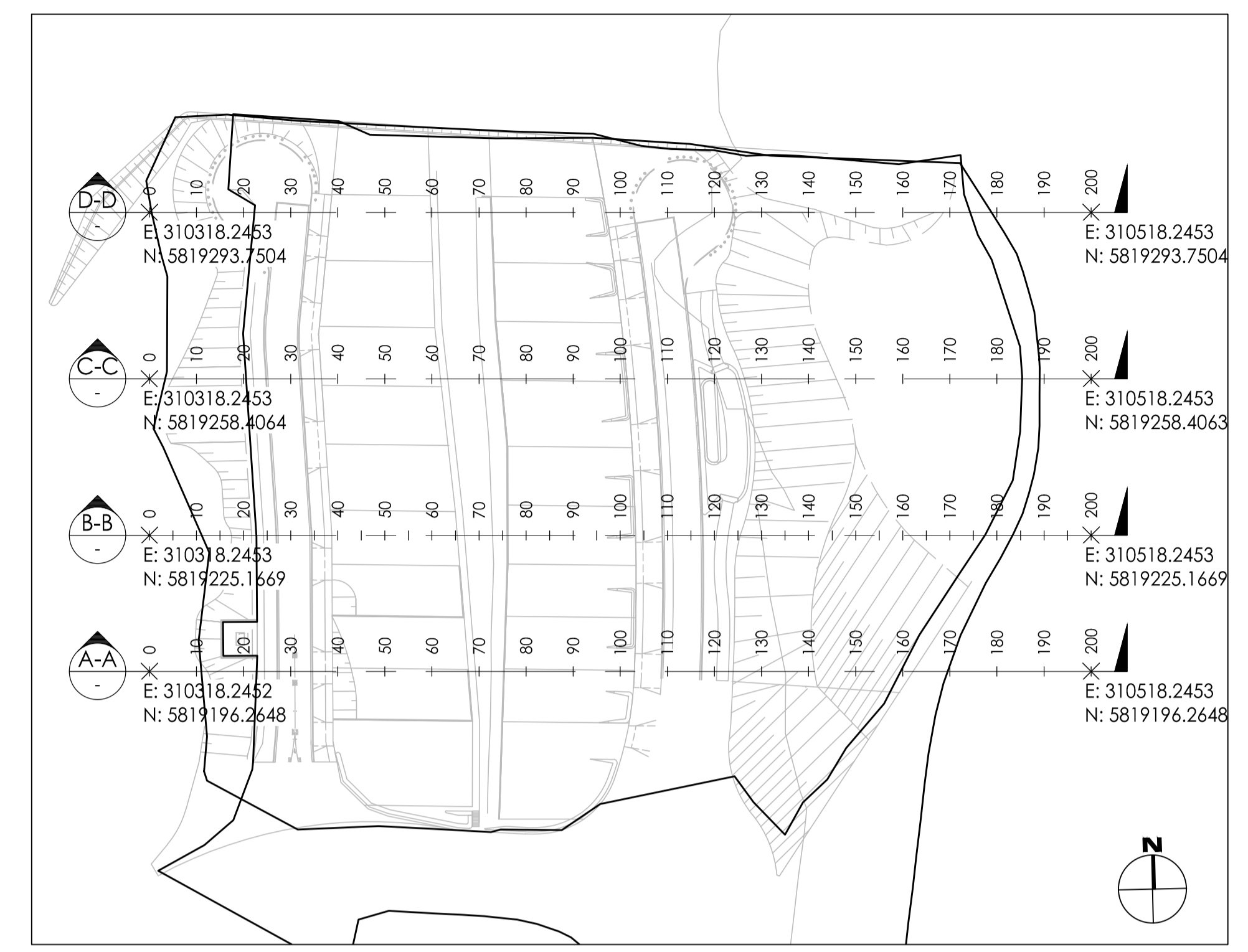
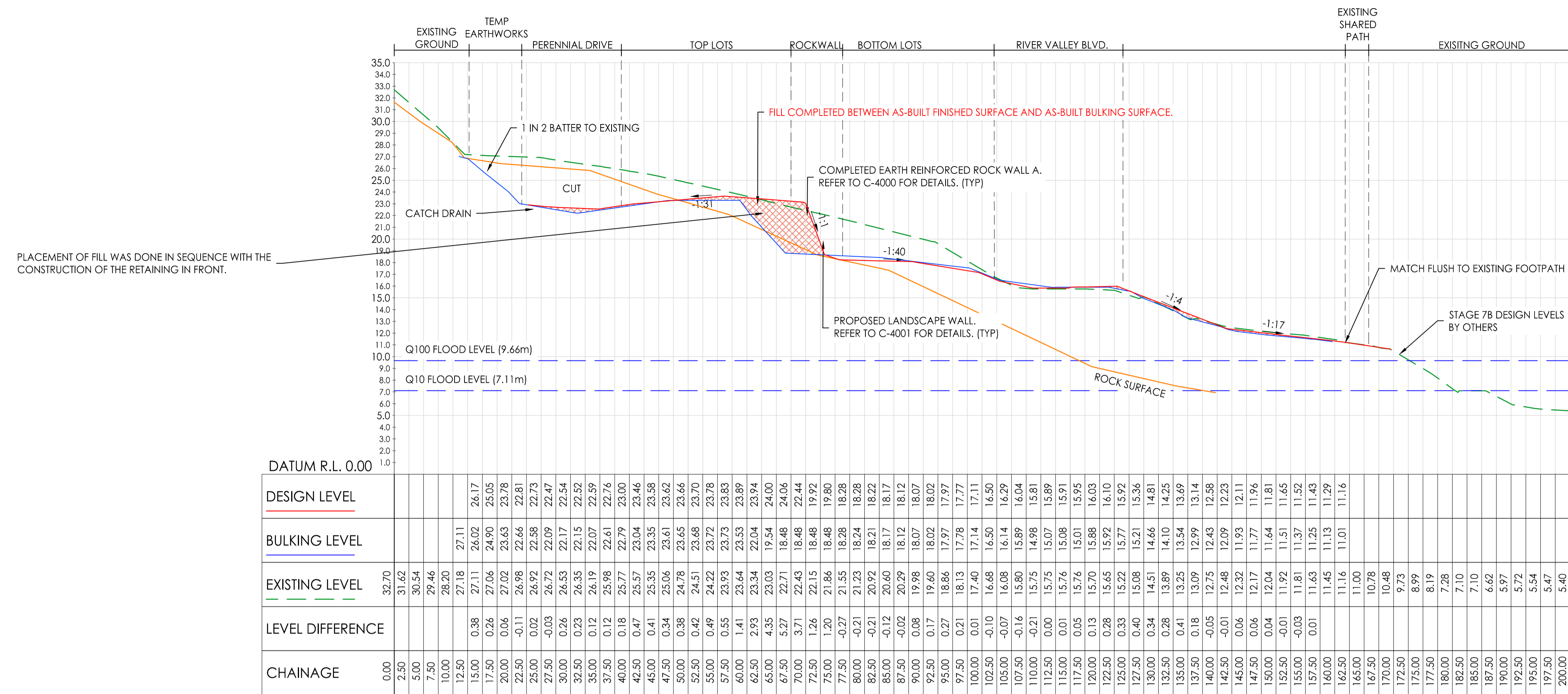

**Note for Contractors**  
 The works described on this drawing must be undertaken by competent Contractors with an appropriate level of experience who have prepared appropriate Safe Work Method Statements (SWMS) relating to these works. The contractor is responsible for the management of all risks associated with the construction activities stated on this drawing.

This drawing should not be issued in part and must be read in conjunction with all appropriate specifications, notes pages, details and authority drawings as appropriate.

Deal before you dig. BEWARE OF UNDERGROUND SERVICES. The location of underground services are approximate only and their exact position should be proven on site. No guarantee is given that existing services are shown.

**BULK EARTHWORKS COMPLETED UNDER EARLY WORKS PACKAGE & APPROVAL. REFER ENDORSED EARLY WORKS PACKAGE FOR FURTHER INFORMATION.**

**SITE SECTIONS ARE PROVIDED FOR ILLUSTRATIVE PURPOSES ONLY AND ARE NOT TO BE USED TO SET OUT THE WORKS.**



**CIVIL SITEWORKS**  
 MELBOURNE  
 T: (03) 938 2800 | E: info@cjarms.com | W: www.cjarms.com

Project: RIVER VALLEY - STAGE 7C  
 Client: YOURLAND  
 Issue of this drawing: ISSUED FOR INFORMATION

Drawn By: TS  
 Checked By: VR  
 Drawn Scale: 1:500 @ A1  
 Date of First Issue: 12.11.22

Project Number	Design	Issue	Level	Rev Type	Reason	Revision
15019	CJA	7C	XX	DR	C	9601 P01

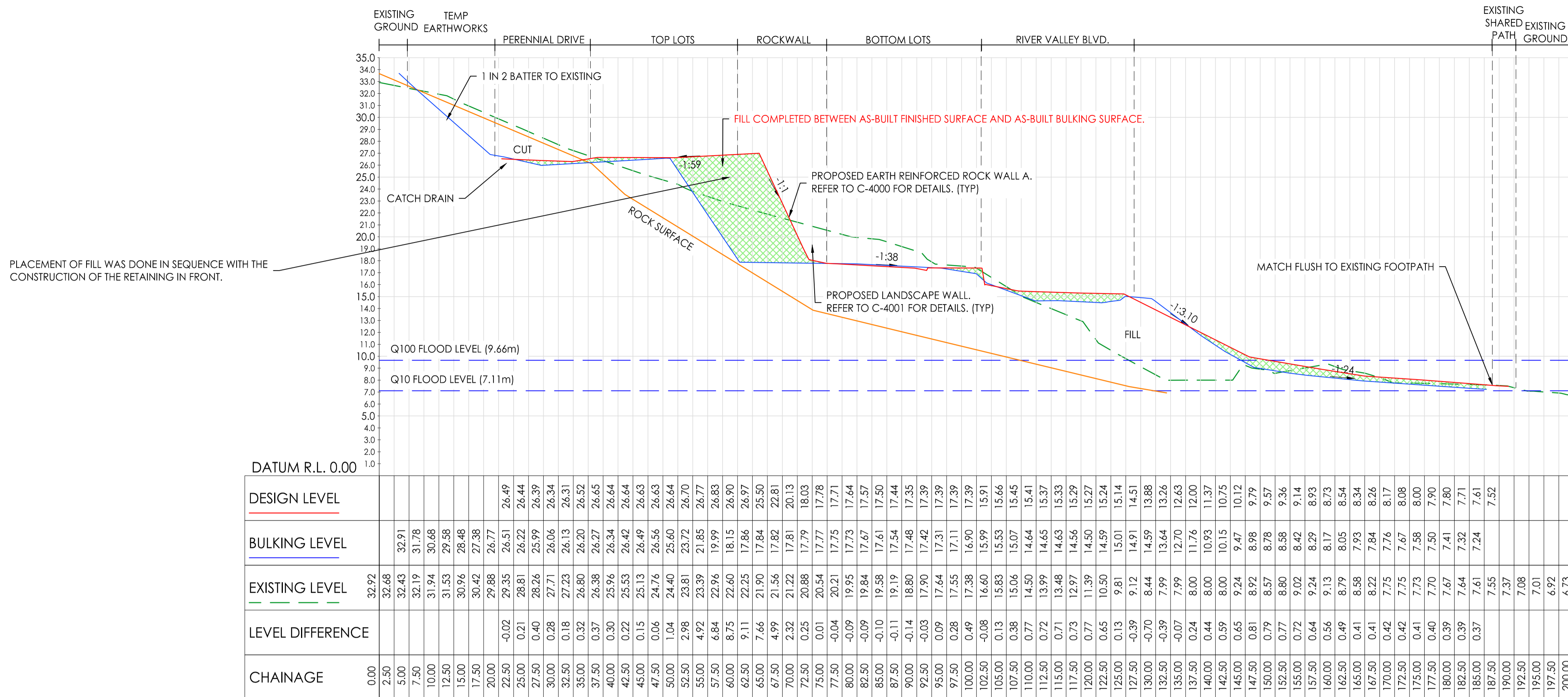

C-C - LONG SECTION  
 SCALES: HORIZONTAL 1:250 VERTICAL 1:125 (2x)

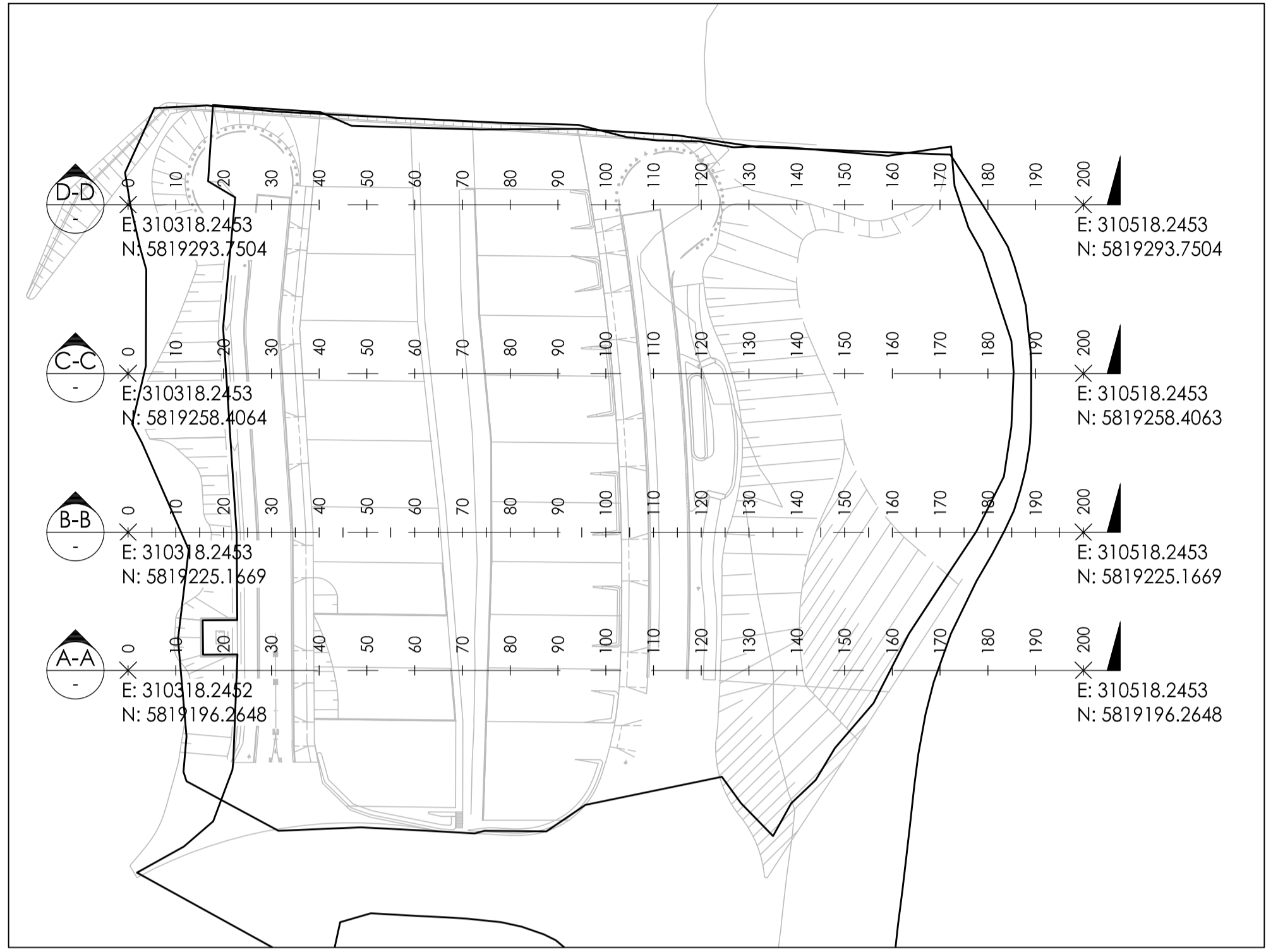

KEY PLAN  
 SCALE 1:1000

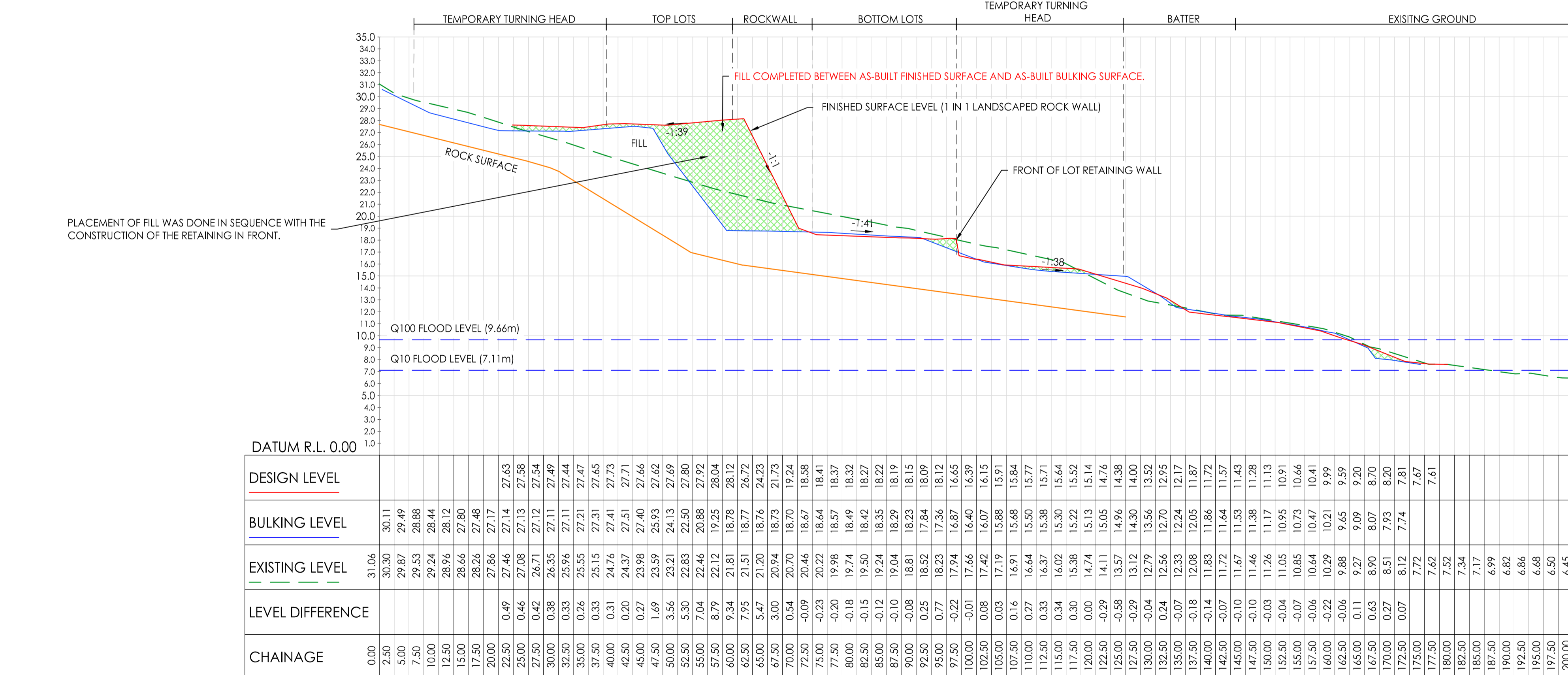

D-D - LONG SECTION  
 SCALES: HORIZONTAL 1:250 VERTICAL 1:125 (2x)

**Note for Contractors**  
 The works described on this drawing must be undertaken by competent Contractors with an appropriate level of experience who have prepared appropriate Safe Work Method Statements (SWMS) relating to these works. The contractor is responsible for the management of all risks associated with the construction activities stated on this drawing.

This drawing should not be issued in part and must be read in conjunction with all appropriate specifications, notes pages, details and authority drawings as appropriate.

Deal before you dig. BEWARE OF UNDERGROUND SERVICES. The location of underground services are approximate only and their exact position should be proven on site. No guarantee is given that existing services are shown.

BULK EARTHWORKS COMPLETED UNDER EARLY WORKS PACKAGE & APPROVAL.  
 REFER ENDORSED EARLY WORKS PACKAGE FOR FURTHER INFORMATION.

SITE SECTIONS ARE PROVIDED FOR ILLUSTRATIVE PURPOSES ONLY AND ARE NOT TO BE USED TO SET OUT THE WORKS.

**ISSUED FOR CONSTRUCTION**



**CIVIL SITWORKS**

Project: RIVER VALLEY - STAGE 7C  
 Client: YOURLAND  
 Issued for Information

Drawn By	Checked By	Drawn Scale	Date of First Issue
TS	VR	1:500 @ A1	12.12.22

Project Number	Discipline	Sheet	Level	Rev Type	Revised	Number	Revision
15019	CJA	7C	XX	DR	C	9602	P01

# Appendix C Lot Fill Certificate

---

## CONTROLLED FILL CERTIFICATE - LEVEL 1 INSPECTION &amp; TESTING

PROJECT : River Valley Stage 7C,  
Lots 11, (Upper Lots)

REF: 1000780.1000

CLIENT : Maribyrnong Riverside Development Pty Ltd  
Level 1, 68 Clarke Street  
Southbank VIC 3006

DATE: 3 February 2023

## SUMMARY

Chadwick Geotechnics Pty Ltd conducted, Level 1 inspection and testing, in accordance with Section 8.2 Level 1 inspection and Testing *AS3798-2007, Guidelines on earthworks for commercial and residential developments*, during the filling of the site.

So far as can be determined, the fill was placed in accordance with the Specification that required a minimum density ratio of 95% of HILF Density (AS1289.5.7.1) to be achieved.

## LIMITATIONS

This Certificate has been commissioned for the filling of the area mentioned above. No responsibility or liability will be accepted for the use of this report for any purpose other than that for which Chadwick Geotechnics Pty Ltd was engaged, specifically for Level 1 Inspection and Testing of the structural fill (excluding topsoil).

This report is based on the conditions present and factors affecting the soil at the time of inspection (30 April 2021 and was completed on 30 November 2022). No responsibility or liability will be accepted and Chadwick Geotechnics Pty Ltd is indemnified to the full extent permitted by law in respect of the use of this Certificate where there has been a change in the nature of the project, or in the site conditions since the site testing.

## TONKIN &amp; TAYLOR PTY LTD



Sotir Stojcevski  
Project Manager



Suresh Seetharaman  
Associate Geotechnical Engineer



Trevor Smith  
Project Director

© Chadwick Geotechnics Pty Ltd.

No part of this publication may be reproduced, stored in a retrieval system or transmitted in any form or by any means, electronic, mechanical, photocopying or otherwise other than in accordance with the limitations and for the purpose provided for above.

[www.chadwickgeotechnics.com.au](http://www.chadwickgeotechnics.com.au)

## CONTROLLED FILL CERTIFICATE - LEVEL 1 INSPECTION &amp; TESTING

PROJECT : River Valley Stage 7C,  
Lots 12, (Upper Lots)

REF: 1000780.1000

CLIENT : Maribyrnong Riverside Development Pty Ltd  
Level 1, 68 Clarke Street  
Southbank VIC 3006

DATE: 3 February 2023

## SUMMARY

Chadwick Geotechnics Pty Ltd conducted, Level 1 inspection and testing, in accordance with Section 8.2 Level 1 inspection and Testing *AS3798-2007, Guidelines on earthworks for commercial and residential developments*, during the filling of the site.

So far as can be determined, the fill was placed in accordance with the Specification that required a minimum density ratio of 95% of HILF Density (AS1289.5.7.1) to be achieved.

## LIMITATIONS

This Certificate has been commissioned for the filling of the area mentioned above. No responsibility or liability will be accepted for the use of this report for any purpose other than that for which Chadwick Geotechnics Pty Ltd was engaged, specifically for Level 1 Inspection and Testing of the structural fill (excluding topsoil).

This report is based on the conditions present and factors affecting the soil at the time of inspection (30 April 2021 and was completed on 30 November 2022). No responsibility or liability will be accepted and Chadwick Geotechnics Pty Ltd is indemnified to the full extent permitted by law in respect of the use of this Certificate where there has been a change in the nature of the project, or in the site conditions since the site testing.

## TONKIN &amp; TAYLOR PTY LTD



Sotir Stojcevski  
Project Manager

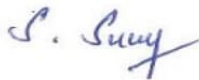

Suresh Seetharaman  
Associate Geotechnical Engineer



Trevor Smith  
Project Director

© Chadwick Geotechnics Pty Ltd.

No part of this publication may be reproduced, stored in a retrieval system or transmitted in any form or by any means, electronic, mechanical, photocopying or otherwise other than in accordance with the limitations and for the purpose provided for above.

[www.chadwickgeotechnics.com.au](http://www.chadwickgeotechnics.com.au)



## CONTROLLED FILL CERTIFICATE - LEVEL 1 INSPECTION &amp; TESTING

PROJECT : River Valley Stage 7C,  
Lots 13, (Upper Lots)

REF: 1000780.1000

CLIENT : Maribyrnong Riverside Development Pty Ltd  
Level 1, 68 Clarke Street  
Southbank VIC 3006

DATE: 3 February 2023

## SUMMARY

Chadwick Geotechnics Pty Ltd conducted, Level 1 inspection and testing, in accordance with Section 8.2 Level 1 inspection and Testing *AS3798-2007, Guidelines on earthworks for commercial and residential developments*, during the filling of the site.

So far as can be determined, the fill was placed in accordance with the Specification that required a minimum density ratio of 95% of HILF Density (AS1289.5.7.1) to be achieved.

## LIMITATIONS

This Certificate has been commissioned for the filling of the area mentioned above. No responsibility or liability will be accepted for the use of this report for any purpose other than that for which Chadwick Geotechnics Pty Ltd was engaged, specifically for Level 1 Inspection and Testing of the structural fill (excluding topsoil).

This report is based on the conditions present and factors affecting the soil at the time of inspection (30 April 2021 and was completed on 30 November 2022). No responsibility or liability will be accepted and Chadwick Geotechnics Pty Ltd is indemnified to the full extent permitted by law in respect of the use of this Certificate where there has been a change in the nature of the project, or in the site conditions since the site testing.

## TONKIN &amp; TAYLOR PTY LTD



Sotir Stojcevski  
Project Manager

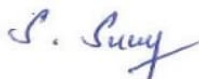

Suresh Seetharaman  
Associate Geotechnical Engineer



Trevor Smith  
Project Director

© Chadwick Geotechnics Pty Ltd.

No part of this publication may be reproduced, stored in a retrieval system or transmitted in any form or by any means, electronic, mechanical, photocopying or otherwise other than in accordance with the limitations and for the purpose provided for above.

[www.chadwickgeotechnics.com.au](http://www.chadwickgeotechnics.com.au)

## CONTROLLED FILL CERTIFICATE - LEVEL 1 INSPECTION &amp; TESTING

PROJECT : River Valley Stage 7C,  
Lots 14, (Upper Lots)

REF: 1000780.1000

CLIENT : Maribyrnong Riverside Development Pty Ltd  
Level 1, 68 Clarke Street  
Southbank VIC 3006

DATE: 3 February 2023

## SUMMARY

Chadwick Geotechnics Pty Ltd conducted, Level 1 inspection and testing, in accordance with Section 8.2 Level 1 inspection and Testing *AS3798-2007, Guidelines on earthworks for commercial and residential developments*, during the filling of the site.

So far as can be determined, the fill was placed in accordance with the Specification that required a minimum density ratio of 95% of HILF Density (AS1289.5.7.1) to be achieved.

## LIMITATIONS

This Certificate has been commissioned for the filling of the area mentioned above. No responsibility or liability will be accepted for the use of this report for any purpose other than that for which Chadwick Geotechnics Pty Ltd was engaged, specifically for Level 1 Inspection and Testing of the structural fill (excluding topsoil).

This report is based on the conditions present and factors affecting the soil at the time of inspection (30 April 2021 and was completed on 30 November 2022). No responsibility or liability will be accepted and Chadwick Geotechnics Pty Ltd is indemnified to the full extent permitted by law in respect of the use of this Certificate where there has been a change in the nature of the project, or in the site conditions since the site testing.

## TONKIN &amp; TAYLOR PTY LTD



Sotir Stojcevski  
Project Manager

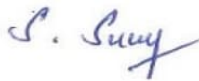

Suresh Seetharaman  
Associate Geotechnical Engineer



Trevor Smith  
Project Director

© Chadwick Geotechnics Pty Ltd.

No part of this publication may be reproduced, stored in a retrieval system or transmitted in any form or by any means, electronic, mechanical, photocopying or otherwise other than in accordance with the limitations and for the purpose provided for above.

[www.chadwickgeotechnics.com.au](http://www.chadwickgeotechnics.com.au)

## CONTROLLED FILL CERTIFICATE - LEVEL 1 INSPECTION &amp; TESTING

PROJECT : River Valley Stage 7C,  
Lots 15, (Upper Lots)

REF: 1000780.1000

CLIENT : Maribyrnong Riverside Development Pty Ltd  
Level 1, 68 Clarke Street  
Southbank VIC 3006

DATE: 3 February 2023

## SUMMARY

Chadwick Geotechnics Pty Ltd conducted, Level 1 inspection and testing, in accordance with Section 8.2 Level 1 inspection and Testing *AS3798-2007, Guidelines on earthworks for commercial and residential developments*, during the filling of the site.

So far as can be determined, the fill was placed in accordance with the Specification that required a minimum density ratio of 95% of HILF Density (AS1289.5.7.1) to be achieved.

## LIMITATIONS

This Certificate has been commissioned for the filling of the area mentioned above. No responsibility or liability will be accepted for the use of this report for any purpose other than that for which Chadwick Geotechnics Pty Ltd was engaged, specifically for Level 1 Inspection and Testing of the structural fill (excluding topsoil).

This report is based on the conditions present and factors affecting the soil at the time of inspection (30 April 2021 and was completed on 30 November 2022). No responsibility or liability will be accepted and Chadwick Geotechnics Pty Ltd is indemnified to the full extent permitted by law in respect of the use of this Certificate where there has been a change in the nature of the project, or in the site conditions since the site testing.

## TONKIN &amp; TAYLOR PTY LTD



Sotir Stojcevski  
Project Manager

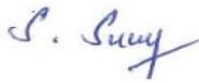

Suresh Seetharaman  
Associate Geotechnical Engineer

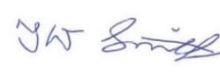

Trevor Smith  
Project Director

© Chadwick Geotechnics Pty Ltd.

No part of this publication may be reproduced, stored in a retrieval system or transmitted in any form or by any means, electronic, mechanical, photocopying or otherwise other than in accordance with the limitations and for the purpose provided for above.

[www.chadwickgeotechnics.com.au](http://www.chadwickgeotechnics.com.au)

## CONTROLLED FILL CERTIFICATE - LEVEL 1 INSPECTION &amp; TESTING

PROJECT : River Valley Stage 7C,  
Lots 16, (Upper Lots)

REF: 1000780.1000

CLIENT : Maribyrnong Riverside Development Pty Ltd  
Level 1, 68 Clarke Street  
Southbank VIC 3006

DATE: 3 February 2023

## SUMMARY

Chadwick Geotechnics Pty Ltd conducted, Level 1 inspection and testing, in accordance with Section 8.2 Level 1 inspection and Testing *AS3798-2007, Guidelines on earthworks for commercial and residential developments*, during the filling of the site.

So far as can be determined, the fill was placed in accordance with the Specification that required a minimum density ratio of 95% of HILF Density (AS1289.5.7.1) to be achieved.

## LIMITATIONS

This Certificate has been commissioned for the filling of the area mentioned above. No responsibility or liability will be accepted for the use of this report for any purpose other than that for which Chadwick Geotechnics Pty Ltd was engaged, specifically for Level 1 Inspection and Testing of the structural fill (excluding topsoil).

This report is based on the conditions present and factors affecting the soil at the time of inspection (30 April 2021 and was completed on 30 November 2022). No responsibility or liability will be accepted and Chadwick Geotechnics Pty Ltd is indemnified to the full extent permitted by law in respect of the use of this Certificate where there has been a change in the nature of the project, or in the site conditions since the site testing.

## TONKIN &amp; TAYLOR PTY LTD



Sotir Stojcevski  
Project Manager

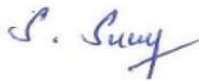

Suresh Seetharaman  
Associate Geotechnical Engineer



Trevor Smith  
Project Director

© Chadwick Geotechnics Pty Ltd.

No part of this publication may be reproduced, stored in a retrieval system or transmitted in any form or by any means, electronic, mechanical, photocopying or otherwise other than in accordance with the limitations and for the purpose provided for above.

[www.chadwickgeotechnics.com.au](http://www.chadwickgeotechnics.com.au)

## CONTROLLED FILL CERTIFICATE - LEVEL 1 INSPECTION &amp; TESTING

PROJECT : River Valley Stage 7C,  
Lots 17, (Upper Lots)

REF: 1000780.1000

CLIENT : Maribyrnong Riverside Development Pty Ltd  
Level 1, 68 Clarke Street  
Southbank VIC 3006

DATE: 3 February 2023

## SUMMARY

Chadwick Geotechnics Pty Ltd conducted, Level 1 inspection and testing, in accordance with Section 8.2 Level 1 inspection and Testing *AS3798-2007, Guidelines on earthworks for commercial and residential developments*, during the filling of the site.

So far as can be determined, the fill was placed in accordance with the Specification that required a minimum density ratio of 95% of HILF Density (AS1289.5.7.1) to be achieved.

## LIMITATIONS

This Certificate has been commissioned for the filling of the area mentioned above. No responsibility or liability will be accepted for the use of this report for any purpose other than that for which Chadwick Geotechnics Pty Ltd was engaged, specifically for Level 1 Inspection and Testing of the structural fill (excluding topsoil).

This report is based on the conditions present and factors affecting the soil at the time of inspection (30 April 2021 and was completed on 30 November 2022). No responsibility or liability will be accepted and Chadwick Geotechnics Pty Ltd is indemnified to the full extent permitted by law in respect of the use of this Certificate where there has been a change in the nature of the project, or in the site conditions since the site testing.

## TONKIN &amp; TAYLOR PTY LTD



Sotir Stojcevski  
Project Manager

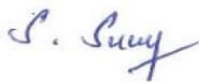

Suresh Seetharaman  
Associate Geotechnical Engineer



Trevor Smith  
Project Director

© Chadwick Geotechnics Pty Ltd.

No part of this publication may be reproduced, stored in a retrieval system or transmitted in any form or by any means, electronic, mechanical, photocopying or otherwise other than in accordance with the limitations and for the purpose provided for above.

[www.chadwickgeotechnics.com.au](http://www.chadwickgeotechnics.com.au)

## CONTROLLED FILL CERTIFICATE - LEVEL 1 INSPECTION &amp; TESTING

PROJECT : River Valley Stage 7C,  
Lots 18, (Upper Lots)

REF: 1000780.1000

CLIENT : Maribyrnong Riverside Development Pty Ltd  
Level 1, 68 Clarke Street  
Southbank VIC 3006

DATE: 3 February 2023

## SUMMARY

Chadwick Geotechnics Pty Ltd conducted, Level 1 inspection and testing, in accordance with Section 8.2 Level 1 inspection and Testing *AS3798-2007, Guidelines on earthworks for commercial and residential developments*, during the filling of the site.

So far as can be determined, the fill was placed in accordance with the Specification that required a minimum density ratio of 95% of HILF Density (AS1289.5.7.1) to be achieved.

## LIMITATIONS

This Certificate has been commissioned for the filling of the area mentioned above. No responsibility or liability will be accepted for the use of this report for any purpose other than that for which Chadwick Geotechnics Pty Ltd was engaged, specifically for Level 1 Inspection and Testing of the structural fill (excluding topsoil).

This report is based on the conditions present and factors affecting the soil at the time of inspection (30 April 2021 and was completed on 30 November 2022). No responsibility or liability will be accepted and Chadwick Geotechnics Pty Ltd is indemnified to the full extent permitted by law in respect of the use of this Certificate where there has been a change in the nature of the project, or in the site conditions since the site testing.

## TONKIN &amp; TAYLOR PTY LTD



Sotir Stojcevski  
Project Manager

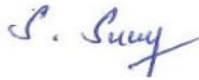

Suresh Seetharaman  
Associate Geotechnical Engineer

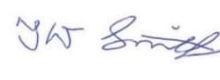

Trevor Smith  
Project Director

© Chadwick Geotechnics Pty Ltd.

No part of this publication may be reproduced, stored in a retrieval system or transmitted in any form or by any means, electronic, mechanical, photocopying or otherwise other than in accordance with the limitations and for the purpose provided for above.

[www.chadwickgeotechnics.com.au](http://www.chadwickgeotechnics.com.au)

## CONTROLLED FILL CERTIFICATE - LEVEL 1 INSPECTION &amp; TESTING

PROJECT : River Valley Stage 7C,  
Lots 19, (Upper Lots)

REF: 1000780.1000

CLIENT : Maribyrnong Riverside Development Pty Ltd  
Level 1, 68 Clarke Street  
Southbank VIC 3006

DATE: 3 February 2023

## SUMMARY

Chadwick Geotechnics Pty Ltd conducted, Level 1 inspection and testing, in accordance with Section 8.2 Level 1 inspection and Testing *AS3798-2007, Guidelines on earthworks for commercial and residential developments*, during the filling of the site.

So far as can be determined, the fill was placed in accordance with the Specification that required a minimum density ratio of 95% of HILF Density (AS1289.5.7.1) to be achieved.

## LIMITATIONS

This Certificate has been commissioned for the filling of the area mentioned above. No responsibility or liability will be accepted for the use of this report for any purpose other than that for which Chadwick Geotechnics Pty Ltd was engaged, specifically for Level 1 Inspection and Testing of the structural fill (excluding topsoil).

This report is based on the conditions present and factors affecting the soil at the time of inspection (30 April 2021 and was completed on 30 November 2022). No responsibility or liability will be accepted and Chadwick Geotechnics Pty Ltd is indemnified to the full extent permitted by law in respect of the use of this Certificate where there has been a change in the nature of the project, or in the site conditions since the site testing.

## TONKIN &amp; TAYLOR PTY LTD



Sotir Stojcevski  
Project Manager

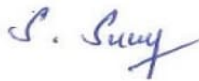

Suresh Seetharaman  
Associate Geotechnical Engineer



Trevor Smith  
Project Director

© Chadwick Geotechnics Pty Ltd.

No part of this publication may be reproduced, stored in a retrieval system or transmitted in any form or by any means, electronic, mechanical, photocopying or otherwise other than in accordance with the limitations and for the purpose provided for above.

[www.chadwickgeotechnics.com.au](http://www.chadwickgeotechnics.com.au)

## CONTROLLED FILL CERTIFICATE - LEVEL 1 INSPECTION &amp; TESTING

PROJECT : River Valley Stage 7C,  
Lots 20, (Upper Lots)

REF: 1000780.1000

CLIENT : Maribyrnong Riverside Development Pty Ltd  
Level 1, 68 Clarke Street  
Southbank VIC 3006

DATE: 3 February 2023

## SUMMARY

Chadwick Geotechnics Pty Ltd conducted, Level 1 inspection and testing, in accordance with Section 8.2 Level 1 inspection and Testing *AS3798-2007, Guidelines on earthworks for commercial and residential developments*, during the filling of the site.

So far as can be determined, the fill was placed in accordance with the Specification that required a minimum density ratio of 95% of HILF Density (AS1289.5.7.1) to be achieved.

## LIMITATIONS

This Certificate has been commissioned for the filling of the area mentioned above. No responsibility or liability will be accepted for the use of this report for any purpose other than that for which Chadwick Geotechnics Pty Ltd was engaged, specifically for Level 1 Inspection and Testing of the structural fill (excluding topsoil).

This report is based on the conditions present and factors affecting the soil at the time of inspection (30 April 2021 and was completed on 30 November 2022). No responsibility or liability will be accepted and Chadwick Geotechnics Pty Ltd is indemnified to the full extent permitted by law in respect of the use of this Certificate where there has been a change in the nature of the project, or in the site conditions since the site testing.

## TONKIN &amp; TAYLOR PTY LTD



Sotir Stojcevski  
Project Manager



Suresh Seetharaman  
Associate Geotechnical Engineer



Trevor Smith  
Project Director

© Chadwick Geotechnics Pty Ltd.

No part of this publication may be reproduced, stored in a retrieval system or transmitted in any form or by any means, electronic, mechanical, photocopying or otherwise other than in accordance with the limitations and for the purpose provided for above.

[www.chadwickgeotechnics.com.au](http://www.chadwickgeotechnics.com.au)